

CERTIFIED LAND CORNER RECORDATION

DESCRIPTION OF CORNER EVIDENCE FOUND, AND ORIGINAL RECORD (if known)

<p>LOCATION</p> <p>S. 9 S.10 S.16 S.15</p> <p>T.18N., R.63W. 6th P.M.</p>	<p>Found "WCCR" stone lying on cut south of road.</p> <p>Corner re-established by single proportionate measurement.</p> <p>G.L.O. record - Sandstone, 18 x 12 x 6. Contract survey by Charles A. Caton in 1873.</p>
---	---

DESCRIPTION OF MONUMENT AND ACCESSORIES ESTABLISHED TO PERPETUATE THE ORIGINAL LOCATION OF THIS CORNER:

At the corner: Corner falls in traveled way of road, no monument set.

Accessories: A 1½" dia. x 30" long iron pipe with brass cap, set and marked as a Witness Corner bears N 0°12' W, 40.00 feet distant.

Raised a rock mound, 3 feet south of witness corner.

SKETCH, WITH COURSE AND DISTANCE TO ADJACENT CORNER IF DETERMINED IN THIS SURVEY.
(May Sketch or Paste Reproduction on Reverse Side.)

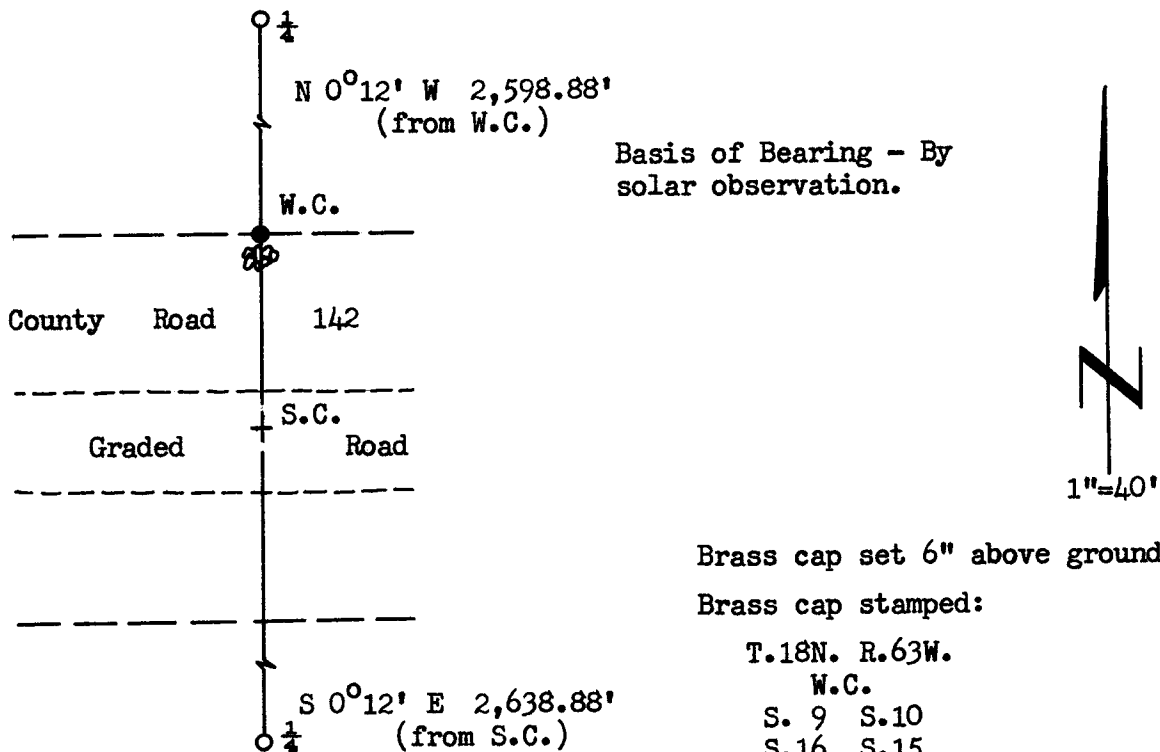

LS 519 1972

I, R.L. Hudson certify that I have carefully performed or reviewed the work done on the diagrammed corner as reported on this recordation form and approve the same.

R.L. Hudson Wyoming L.S. No. 519
 Signature of Surveyor Registration No.

STATE OF WYOMING,
Office of Clerk and Recorder,
County of Laramie

This "corner record" was filed for record on the 30th day of October, 1972, was noted on the cross-index plat and is assigned page No. 18-63, in book No. ONE

John B. Hillman
 County Official

Cross Index No. _____	T. _____	R. _____	Mer. _____
_____	T. _____	R. _____	Mer. _____
_____	T. _____	R. _____	Mer. _____
_____	T. _____	R. _____	Mer. _____
_____	T. _____	R. _____	Mer. _____
_____	T. _____	R. _____	Mer. _____
_____	T. _____	R. _____	Mer. _____

The State of Wyoming }
County of Laramie } SS

This instrument was filed for record
at 8:01 o'clock P.M. on the
30th day of October
A. D. 19 22 and duly recorded in
Book on page

John B. Williams

County Clerk & Ex-Officio Register of Deeds
By _____, Deputy